

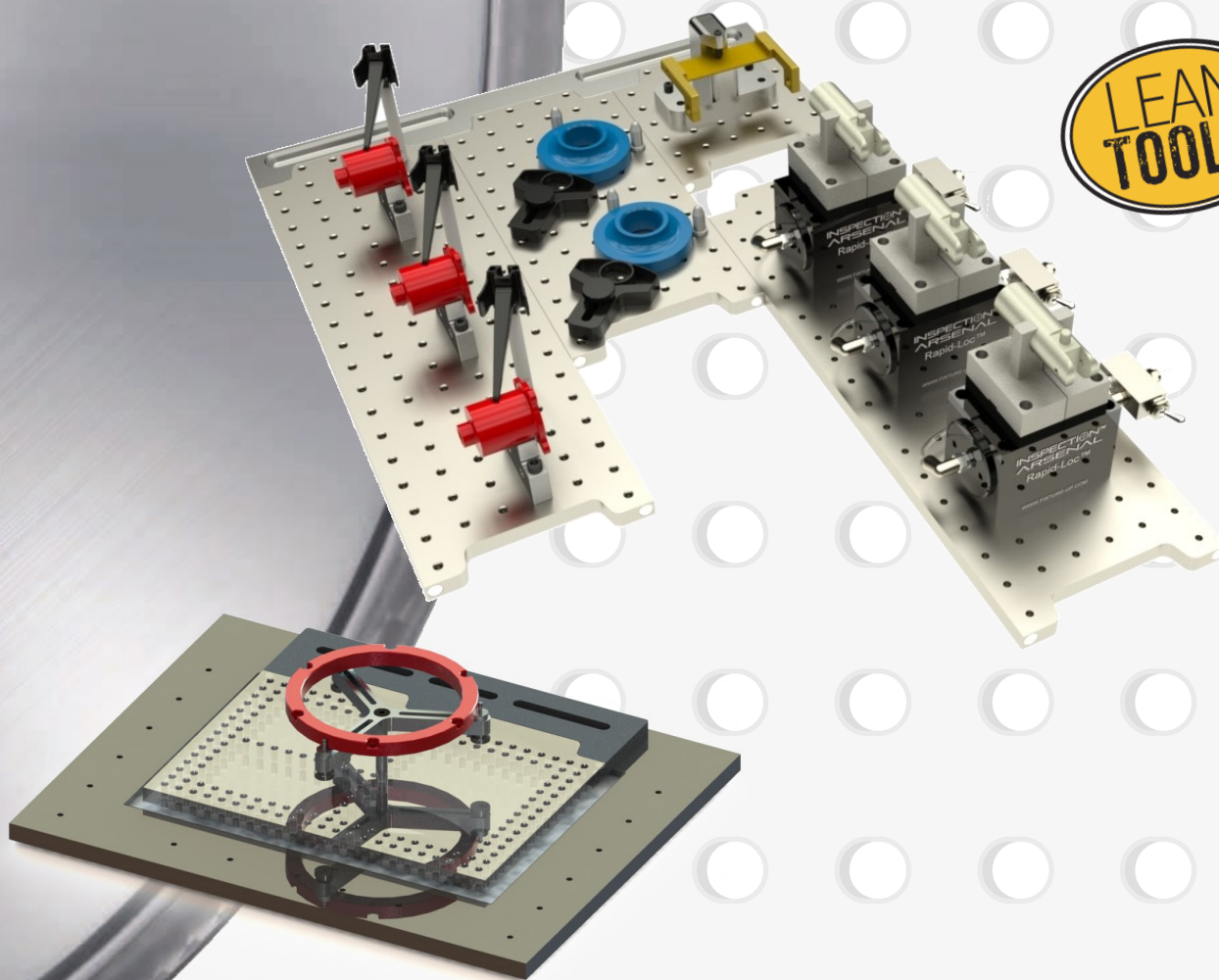

UNIVERSAL FIXTURING

Protect your profits.



**INSPECTION
ARSENAL™**

Products of Phillips Precision, Inc

Starrett®

www.starrett.com

Machine Bundle Reference Guide

Category	Model Group	Model Size	Y in	LNL Bundle SKU (INCH in.)	Comments
Comparator	Horiz. Bench OC	HB400	6	SYS60: OCTR03	
Comparator	Horiz. Bench OC	HB400	6	SYS60: OCTR03	
Comparator	Horiz. Bench OC	HD400	6	SYS60: OCTR03	
Comparator	Horiz. Bench OC	HE400	4	SYS60: OCTR03	
Comparator	Horiz. Floor OC	HF600	8	SYS60: OCTR03	
Comparator	Horiz. Floor OC	HF600	8	SYS60: OCTR03	
Comparator	Horiz. Floor OC	HF750	8	SYS60: OCTR03	
Comparator	Horiz. Floor OC	HF750	8	SYS60: OCTR03	
Comparator	Horiz. Floor OC	HS600	8	SYS60: OCTR03	
Comparator	Horiz. Floor OC	HS600	8	SYS60: OCTR03	
Comparator	Horiz. Floor OC	HS750	8	SYS60: OCTR03	
Comparator	Horiz. Floor OC	HS750	8	SYS60: OCTR03	
Comparator	Horiz. Floor OC	VF600	8	SYS60: OCTR03	
Comparator	Horiz. Floor OC	VF600	8	SYS60: OCTR03	
Comparator	Vert. Bench OC	VB300	4	SYS60: OCTR03	
Comparator	Vert. Bench OC	VB400	4	SYS60: OCTR03	
Multi-sensor	Multi-sensor	AV300+	6	SYS01: DK06VIS01	
Multi-sensor	Multi-sensor	AV300+ MICRO	6	SYS01: DK06VIS01	
Multi-sensor	Multi-sensor	AV350+	14	SYS02: DK12VIS01	
Vision (Video Meas.)	Horiz. Floor Video	HDV300	6	SYS01: DK06VIS01	
Vision (Video Meas.)	Horiz. Floor Video	HDV400	6	SYS01: DK06VIS01	
Vision (Video Meas.)	Horiz. Floor Video	HDV500	8	SYS01: DK06VIS01	
Vision (Video Meas.)	Manual Vision	MV300	6	SYS01: DK06VIS01	
Vision (Video Meas.)	Manual Vision	MVR200	4	SYS01: DK06VIS01	
Vision (Video Meas.)	Manual Vision	MVR300	8	SYS01: DK06VIS01	
Vision (Video Meas.)	Vert. Bench Video	AV300	6	SYS01: DK06VIS01	
Vision (Video Meas.)	Vert. Bench Video	AV300 FOV	5	SYS01: DK06VIS01	
Vision (Video Meas.)	Vert. Bench Video	AVR200	4	SYS01: DK06VIS01	
Vision (Video Meas.)	Vert. Bench Video	AVR200 FOV	4	SYS01: DK06VIS01	
Vision (Video Meas.)	Vert. Bench Video	AVR300	8	SYS01: DK06VIS01	
Vision (Video Meas.)	Vert. Bench Video	AVR300 FOV	8	SYS01: DK06VIS01	
Vision (Video Meas.)	Vert. Floor Video	AV350	14	SYS02: DK12VIS01	
Vision (Video Meas.)	Vert. Floor Video	LF463	12	SYS02: DK12VIS01	
Vision (Video Meas.)	Vert. Floor Video	LF713	24	SYS02: DK12VIS01	
Comparator	Horiz. Bench OC	HVR100-FLIP	7	SYSSTR-FLP-1	



OPTICAL COMPARATOR Loc-N-Load™ Bundled Systems by Inspection Arsenal™

Speed up your inspections and enhance the value of your optical comparators with a quick-swap fixture system of interlocking docking rails, fixture plates and work-holding clamps. Alternate set-ups between quick-swap fixture plates. Add fixture plates or mounting hardware as needed.

Purchase preconfigured bundles or purchase items individually. The small docking rail secures to the t-slot table while the magnetically interlocking plates quickly and accurately secure and release. By fixturing on quick-swap plates, operators can change parts in and out without building and breaking down setups. For high quantity part lots, affordable plates can be dedicated and kept with the job box for fast, repeatable setups. Add the work holding kit of your choice!

FLIP BUNDLED SYSTEM

Part #	FLIP BUNDLED SYSTEM	Price
SYSSTR-FLP-1	(1) 6 x 3" Docking Rail, (1) 6 x 12" fixture plates plus 67 pc work holding kit	\$1449
NUT-DT-ASY	Dovetail mounting hardware (1/4-20)	\$29

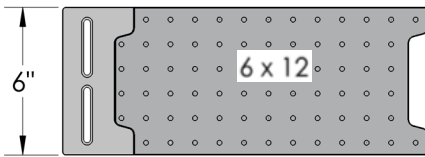

Work holding included in bundle.

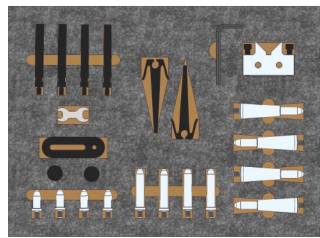

Stand-Off & Rest Pad Set

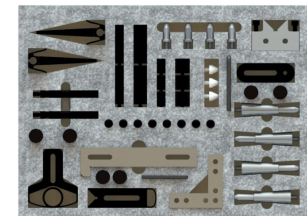
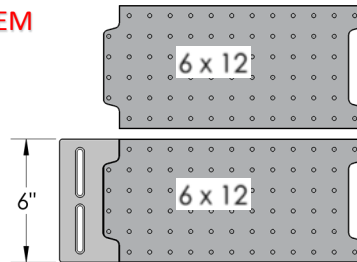

Plate sold separately

COMPLETE FLIP KIT		
V-Block, 1 set of 2	2	
Silver-Bullet™, 4 ea.: 1", 2", 3"	12	
Steel shaft / stand-off, stackable	4	
Trigger-Finger™	2	
Hole Adjuster	2	
Stand-off set (Full set-see chart)	37	
Hex Keys, plus assorted screws	8	
Total	67	

Stand-Off & Rest Pad Set	
Plastic height adjuster	2
Plastic cone	3
1/2" dia. x 3/4" ht. stand-off	3
1/2" dia. x 1" ht. stand-off	6
1/2" dia. x 2" ht. stand-off	3
Thumb screws (1/4-20)	2
1/2" dia. x 1/2" ht. pin rest	3
3/4" dia. x 1/2" ht. pin rest	3
3/4" dia. x 3/4" ht. stand-off	3
3/4" dia. x 1" ht. stand-off	6
3/4" dia. x 2" ht. stand-off	3
Total	37

TRADITIONAL OPTICAL COMPARATOR BUNDLED SYSTEM



Part #	OPTICAL COMPARATOR BUNDLED SYSTEM	Price
SYS60_OC6TR03	(1) 6 x 3" Docking Rail, (2) 6 x 12" fixture plates plus 58-pc work holding kit	\$1,379
NUT-DT-ASY	Dovetail mounting hardware (1/4-20)	\$29

ADDITIONAL PLATES AND ACCESSORIES

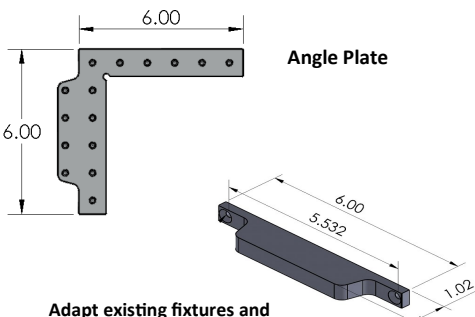

Adapt existing fixtures and standard Starrett accessories.

Clear Anodized Aluminum, .5" thick, 1x1" spacing, 1/4-20 thread holes and work holding.

PLATES	Description	Price
OC-DOCK-06	LNL Dock—6"	\$205
LNL-PLT-0606	LNL Fixture Plate 6 x 6"	\$180
LNL-PLT-0612	LNL Fixture Plate 6 x 12"	\$250
LNL-PLT-0618	LNL Fixture Plate 6 x 18"	\$320
LNL-ADPT-06	Adapter Plate 6 x 1"	\$119
LNL-ANGL-0603	Angle Plate/ Stop 6 x 6"	\$180
WORK HOLDING		
TR-KIT-FLP1	Flip Work Holding Kit - 67 pcs	\$989
TR-KIT-03	Starter Work Holding Kit (58 pcs)	\$659

Add fixture plates and work holding as necessary.

Inquire about metric (M6) for all plates and components.



The Inspection Arsenal™ LEAN fixture concept is available for Vision systems. Docking rails fit the stage of any optical machine. Docking rails are black anodized aluminum. Clear, polycarbonate plates—rails and plates are .5" thick, 1/4-20" holes.

- **Durable, scratch-resistant** polycarbonate plates.
- Leveling feet available.
- More **open viewing area**.
- Blank plates available to customize.
- Dedicate a plate to **gauging** for fast re-calibration.
- Add multiple docking rails and plates for optimal coverage.
- Fixture design and custom plates available.



Choose the bundle combination of Open-Sight™ Docking Rail and fixture plates to suit your needs. OR, bundle your own system from the list of options on Page 2. These bundled systems include the work holding kit shown below. Add docking rails on sides of stage to create more "locations" for inspection. Order blank plates and add only holes you need for greater savings.

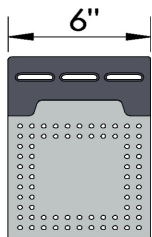

(SYS01) 6" VISION Bundle
+ VISION KIT
\$967

6x6

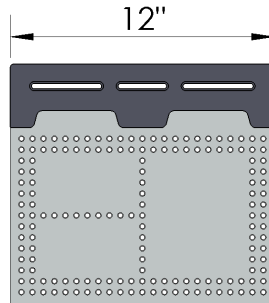

(SYS02) 12" VISION Bundle
+ VISION KIT
\$1,297

12 x 8

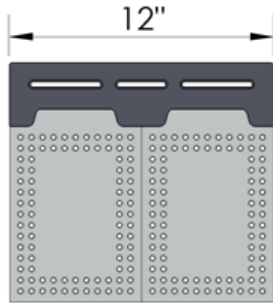

(SYS03) 12" VISION Bundle
+ VISION KIT
\$1,397

6 x 8 6 x 8

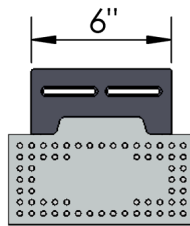

(SYS04) 6" VISION Bundle
+ VISION KIT
\$1,037

8 x 4

See Pg3 for individual plates, docking rails and work holding components

VISION Work Holding Kit

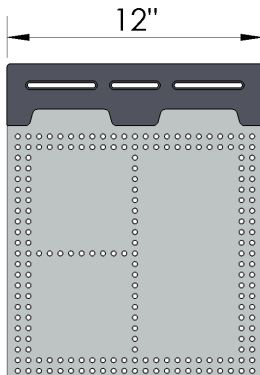
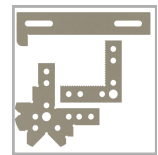
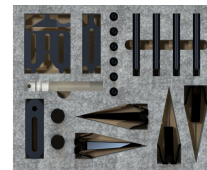

(SYS06) 12" VISION Bundle
+ VISION KIT
\$1,697

12 x 12

OPEN-SIGHT™ BUNDLES: Docking Rail and Plate, Plus VISION KIT

Part #	BUNDLE Description	Price
SYS01_DK06VIS01	1 ea: 6" Dock, 6" plate + VIS-KIT-01	\$967
SYS02_DK12VIS01	1 ea: 12" Dock, 12" plate + VIS-KIT-01	\$1,297
SYS03_DK12VIS01	(1) 12" Dock, (2) 6 x 8 plates + VIS-KIT-01	\$1,397
SYS04_DK06VIS01	1 ea: 6" Dock, 8x4" plate + VIS-KIT-01	\$1,037
SYS06_DK12VIS01	1 ea: 12" Dock, 12 x 12" plate + VIS-KIT-01	\$1,697
<i>Order additional Workholding Kits:</i>		
VIS-KIT-01	Open-Sight™ workholding kit (34pcs)	\$ 497

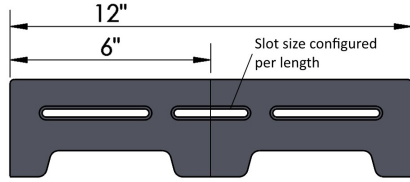

Add Open-Sight™ plates as work requires. Fixture and add to job box.

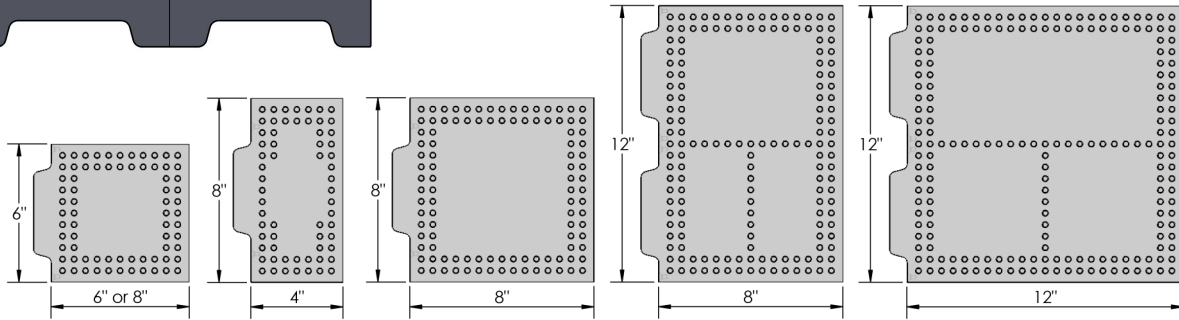

OPEN-SIGHT™ Aluminum Docking Rails and Polycarbonate Plates— .5 thick, 1/4-20 holes, .5" spacing

Part #	Description (Inch)	Price
OS-CORNER-66	Corner Block 6 X 6"	\$195
OS-DOCK-06	Docking Rail 6 x 3"	\$205
OS-DOCK-12	Docking Rail 12 x 3"	\$295
OS-PLT-0606	Plate 6 x 6"	\$255
OS-PLT-0606-B	Plate-Blank 6 x 6"	\$195
OS-PLT-0608	Plate 6 x 8"	\$275
OS-PLT-0804	Plate 8 x 4"	\$325
OS-PLT-0808	Plate 8 x 8"	\$325
OS-PLT-1208	Plate 12 x 8"	\$495
OS-PLT-1208-B	Plate-Blank 12 x 8"	\$395
OS-PLT-1212	Plate 12 x 12"	\$895
LNL-ADPT-06	Adapter Plate 6 x 1"	\$119
CORNER	Aluminum corner block	Call



Spring-action corner block helps you see all around your part

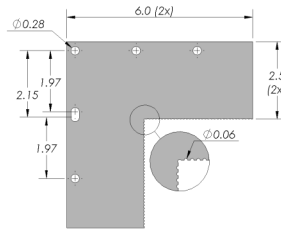

Polycarbonate corner stop.

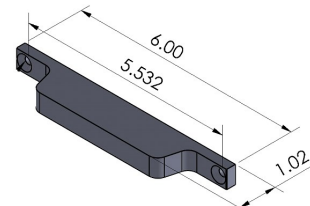
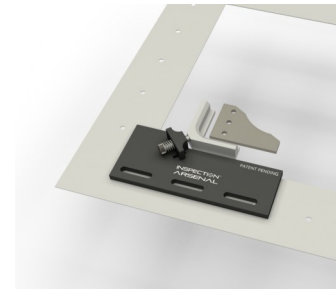

Adapter plate allows you to use existing fixtures.

Work-holding for Open-Sight™ Vision Systems

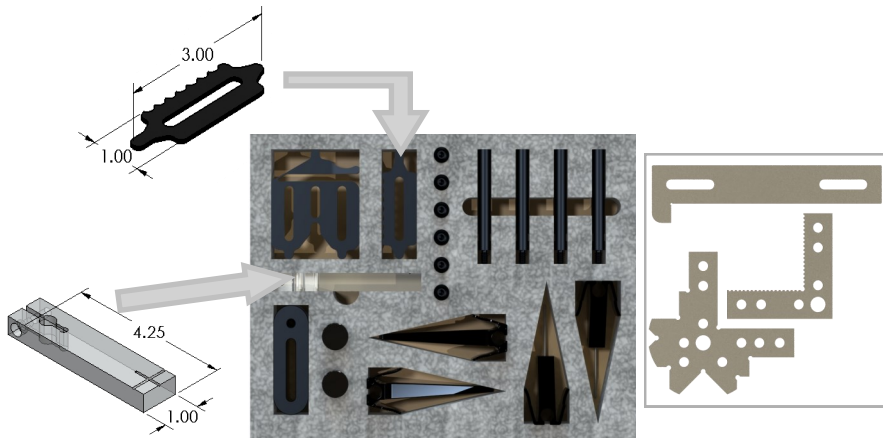

Work Holding components versatile enough to hold most any part.

VIS-KIT-01 — \$497	
VISION Kit (34 pcs)	
Hole Adjuster	2
Adjustable Platform	1
Sliding Stop™ (with 1/4-20 button)	2
Spring-Loc™ (with 1/4-20 button)	2
Simple-Stop™ #01-OS, #06, #07	3
Trigger-Finger™	2
Trigger-Point™	2
Steel shaft/stand-off	4
Hex Key, asst. screws	16
TOTAL	34

slots and hole spacing may be different than shown

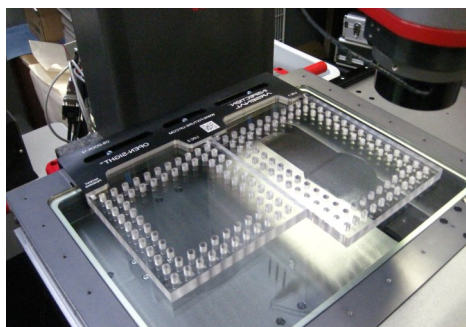

The Inspection Arsenal™ LEAN fixture concept is available for Vision systems. Docking rails fit the stage of any optical machine. Docking rails are black anodized aluminum. Clear, polycarbonate plates—rails and plates are 12.7mm thick, 10mm spacing, M6 holes.

- **Durable, scratch-resistant** polycarbonate plates.
- Leveling feet available.
- More **open viewing area**. Or order blank plates to customize.
- Dedicate a plate to **gauging** for fast re-calibration.

"We are very pleased with the reduction in set up times it offers us allowing quick changeovers between set up. The product is proving to be a great help. We now make our inspection fixtures to attach directly to the rail which allows us to automate more of our inspection programs as we are starting from known locations."

Andrew Walmsley, President at Volo Aero MRO, Springfield, MA

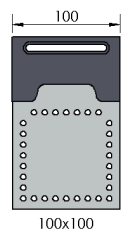

**100mm Bundle
+ VISION KIT
\$1022**

Choose the bundle combination of Open-Sight™ Docking Rail and fixture plates to suit your needs. These bundled systems include the work holding kit shown below.

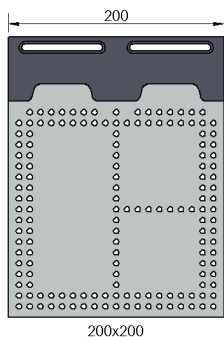
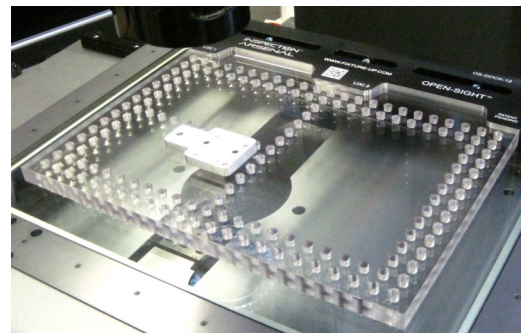

**200mm Bundle
+ VISION KIT
\$1299**

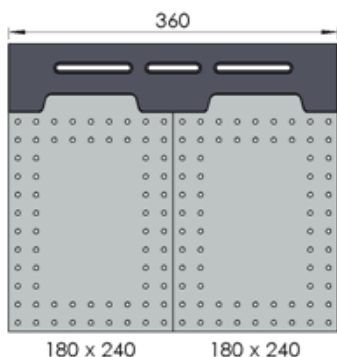

**360mm Bundle
+ VISION KIT
\$1890**

VISION Work Holding Kit

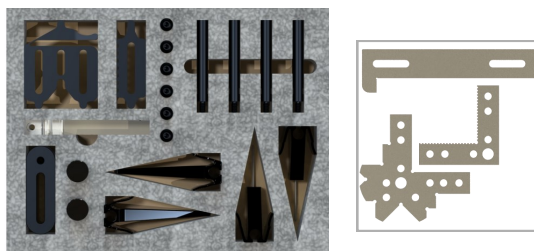

OPEN-SIGHT™ BUNDLES: Docking Rail and Plate, Plus VISION KIT		
Part #	BUNDLE Description	Price
YSYM4_DK100V01	1 ea: 100mm Dock, 100mm plate +VIS-KIT-01M	\$1022
YSYM4_DK200V01	1 ea: 100mm Dock, 100mm plate +VIS-KIT-01M	\$1299
YSYM4_DK360V01	(1) 360mm Dock, (2) 240mm plates +VIS-KIT-01M	\$1890
<i>Order additional Workholding Kits:</i>		
VIS-KIT-01M	Open-Sight™ workholding kit (34pcs), Metric	\$ 597

slots and hole spacing may be different than shown

OPEN-SIGHT™ Vision Fixture Plates— Metric



“We were looking for a quick change fixture system for our CMM’s and believe that your solution is just that! We are always focused on lean activities and as we expand our use of CMM’s on our shop floor this solution will be instrumental in our having a “self serve” inspection process.”

Harvey Smith, VP Operations, Kennebec Technologies



**Add Open-Sight™ plates as work requires.
Fixture and add to job box.**

Open-Sight™ Aluminum Docking Rails and Polycarbonate Plates			
Part #	Description	Size (mm)	Price
OS-DOCK-M100	Docking Rail, 100 mm	100 mm x 60 mm	\$185
OS-DOCK-M200	Docking Rail, 200 mm	200 mm x 60 mm	\$255
OS-DOCK-M360	Docking Rail, 360 mm	360 mm x 75 mm	\$439
OS-M100100	Plate 100 x 100	100 mm x 100 mm	\$250
OS-M200100	Plate 200 x 100	200 mm x 100 mm	\$320
OS-M200200	Plate 200 x 200	200 mm x 200 mm	\$460
OS-M180240	Plate 180 x 240	180 mm x 240 mm	\$429
OS-M100100-B	Blank plate 100 x 100	100 mm x 100 mm	\$225
OS-M200200-B	Blank plate 200 x 200	200 mm x 200 mm	\$410

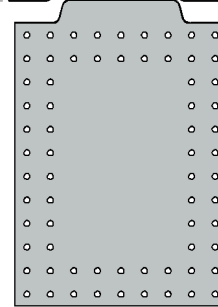
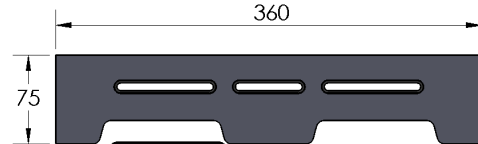

Customize: Order Blank plates (no holes) — and add only holes you need for greater savings.

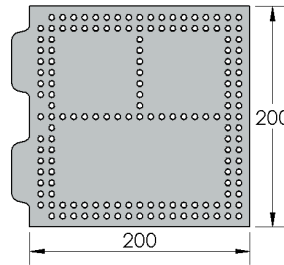
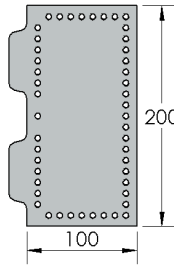
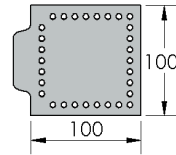
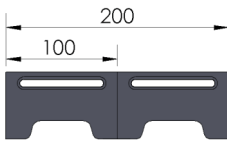

Workholding for Open-Sight™ Vision Systems

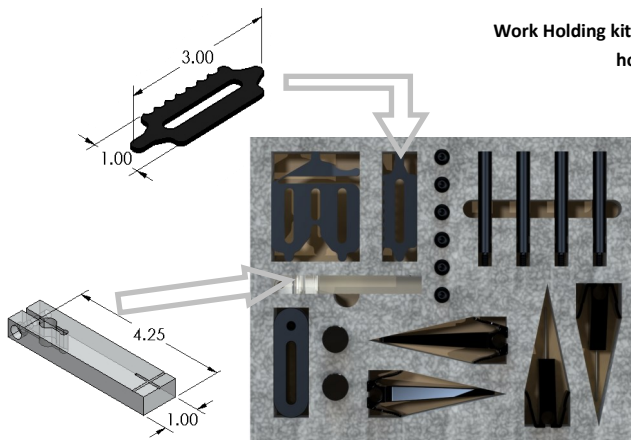

Work Holding kit components versatile enough to hold most any part.

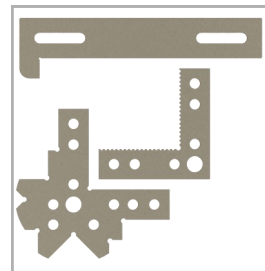

VIS-KIT-01M — \$597

VISION Kit (34 pcs)

Hole Adjuster	2
Adjustable Platform	1
Sliding Stop™ (w/ M6 screws)	2
Spring-Loc™ (w/ M6 screws)	2
Simple-Stop™ #01-OS, #06, #07	3
Trigger-Finger™	2
Trigger-Point™	2
Steel shaft/stand-off	4
Hex Key, asst. screws	16
TOTAL	34

slots and hole spacing may be different than shown



STARTER Kit — \$659 TR-KIT-03

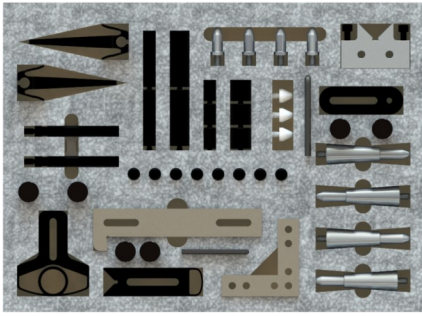

STARTER Kit (58 pcs.)	
Cross-Bow™ Clamp	2
D-Block™ Stop	2
V-Block, 1 set of 2	2
Silver-Bullet™, 4 ea.: 1", 3"	8
Steel shaft / stand-off, stackable	2
Trigger-Finger™	2
Hole Adjuster	2
Simple-Stop™, 2 ea.: #01, #07	4
Stand-offs, assorted sizes	13
Hex Keys, plus assorted screws	21
Total	58

INSPECTION ARSENAL™ — for

- **Fast** trigger-action; Non-marring, low-profile.
- **Stackable**, versatile components.
- **Fixture-up** affordably—Add sets or plates as needed.
- Affordably create multi-part fixtures.
- 1/4-20" threads (inquire about metric)

COMPLETE Kit — \$699 TR-KIT-02

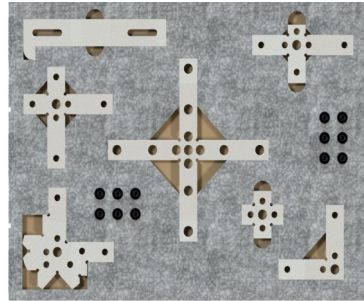
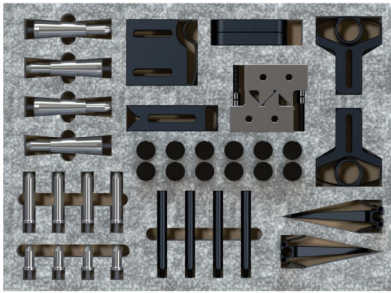

COMPLETE Kit (70 pcs.)	
Cross-Bow™ Clamp	4
D-Block™ Stop	4
Trigger-Block™ Clamp	2
Silver-Bullet™, 4 sets / 3	12
V-Block, 1 set of 2	2
Steel shaft / stand-off, stackable	4
Trigger-Finger™	2
Hole Adjuster	2
Simple-Stop™ Rails, 1 set / 7	7
Hex Keys, plus assorted screws	31
Total	70

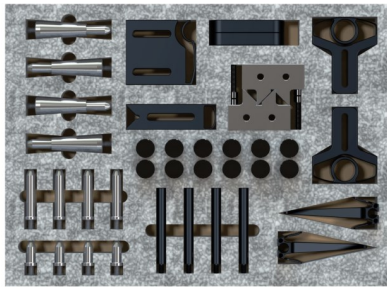

Spring-Loc™, Sliding Stop™

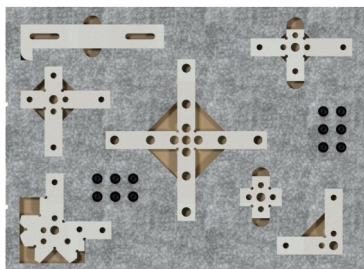

The WORKS Kit — \$2229 TR-KIT-01

The WORKS Kit (146 pcs.)		Qty
Spring Clamps		
Cross-Bow™ Spring Clamp		4
D-Block™ Spring Stop		4
Trigger-Block™ Spring Clamp		2
Trigger-Finger™ hold-downs		2
Stackable steel shafts		4
Spring-Loc™ Low-profile Clamp		2
Risers & Stand-offs		
Silver-Bullet™ Stand-off, 4 Sets / 3		12
V-Block, 1 set of 2		2
Stops & Rails		
Simple-Stop™ Rails, 1 Set / 7		7
Hole Adjuster for Trigger-Finger™		2
Sliding Stop™ Low-profile Stop		2
Hex Keys, plus assorted screws		43
STAND-OFF & RISER SETS		
<i>See next page for Set descriptions</i>		
Stand-Off & Rest Pad Set		37
Magnetic Riser Component Set		23
Total		146
<i>PLUS 55 FOAM DRAWER INSERTS</i>		

The WORKS Kit is a combination of components found in Inspection Arsenal™ sets, including clamps, rails, stand-offs, and magnetic risers.

This kit contains everything you need to create

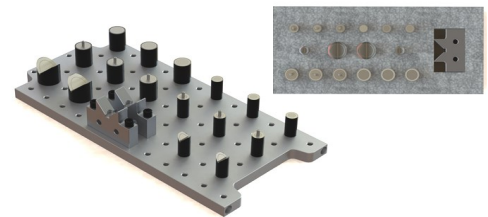

Magnetic Riser Component Set

Plate sold separately

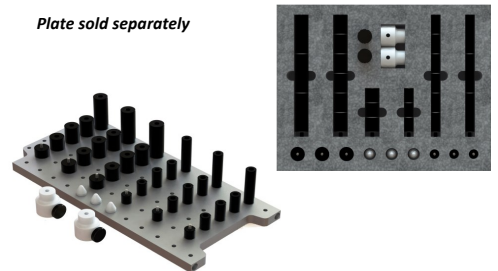

Stand-Off & Rest Pad Set

Plate sold separately

Inquire about metric components.

slots and hole spacing may be different than shown

Magnetic Riser Set —\$989 MAGN-SET-30

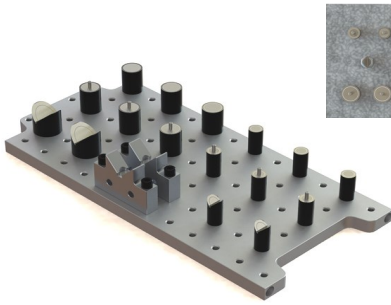

Magnetic Riser Component Set

Plate sold separately

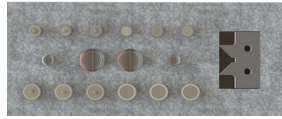

Magnetic clamping allows for unlimited probe access and MORE holding options for steel parts during CMM inspection. Combine with stand-offs and other work-holding kits for fixture building. (1/4-20 threads)

Magnetic Riser Set

1/2" dia. x 1" ht. Magnetic Rest Pad	3
3/4" dia. x 1" ht. Magnetic Rest Pad	3
1/2" dia. x 1" ht. Magnetic Pin Rest	3
3/4" dia. x 1" ht. Magnetic Pin Rest	3
1/2" dia. x 1" ht. Magnetic V stand-off	2
1" dia. x 1" Magnetic V stand-off	2
1" H Magnetic V-Block Set	2
(set includes 1 hex key and 4 bolts)	
Total	23

Stand-Off & Rest Pad Set —\$525 STOF-SET-30



Stand-Off & Rest Pad Set

Plate sold separately

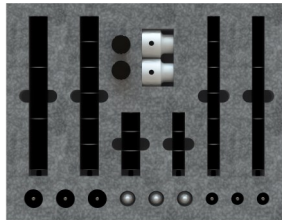

High quality stand-offs and rest pads add flexibility to CMM fixture design. Made of plastic and steel with 1/4-20 threads. Combine with Starter, Complete and The Works kits.

Stand-Off & Rest Pad Set

Plastic height adjuster	2
Plastic cone	3
1/2" dia. x 3/4" ht. stand-off	3
1/2" dia. x 1" ht. stand-off	6
1/2" dia. x 2" ht. stand-off	3
Thumb screws (1/4-20)	2
1/2" dia. x 1/2" ht. pin rest	3
3/4" dia. x 1/2" ht. pin rest	3
3/4" dia. x 3/4" ht. stand-off	3
3/4" dia. x 1" ht. stand-off	6
3/4" dia. x 2" ht. stand-off	3
Total	37

Inquire about metric

Enhanced Stand-Off Set —\$749 STOF-SET-30



Enhanced Stand-Off Set

Plate sold separately



Enhance other work holding with height adjusters and stand-offs that can be angled in any direction. This set adds flexibility to inspection setups. Plastic and steel with 1/4-20 threads. Combine with other kits.

Enhanced Stand-Off Set

1/2" dia. adjustable stand-off	2
3/4" dia. adjustable stand-off	2
3/4" dia. x 1" ht. adjustable knuckle	2
Plastic ht. adjuster	2
1/2" thumb screws	2
Plastic cone	2
1/2" dia. x 1" ht. stand-off	2
3/4" dia. x 1" ht. stand-off	2
Total	16

Inquire about metric

Inspection Arsenal™ provides an arsenal of tools to fight inefficiency and waste. Set up quickly and cleanly with **Trigger-Block™**, **Cross-Bow™** and **D-Block™** non-marring spring clamps, **Trigger-Finger™** hold-down,

Silver-Bullet™ stand-offs, and **Simple-Stop™** low-profile rails and stops. Also available is the new **Riser-Grip™**, which elevates parts for full access, and V-Blocks that can be used horizontally or vertically.

Spring Clamps

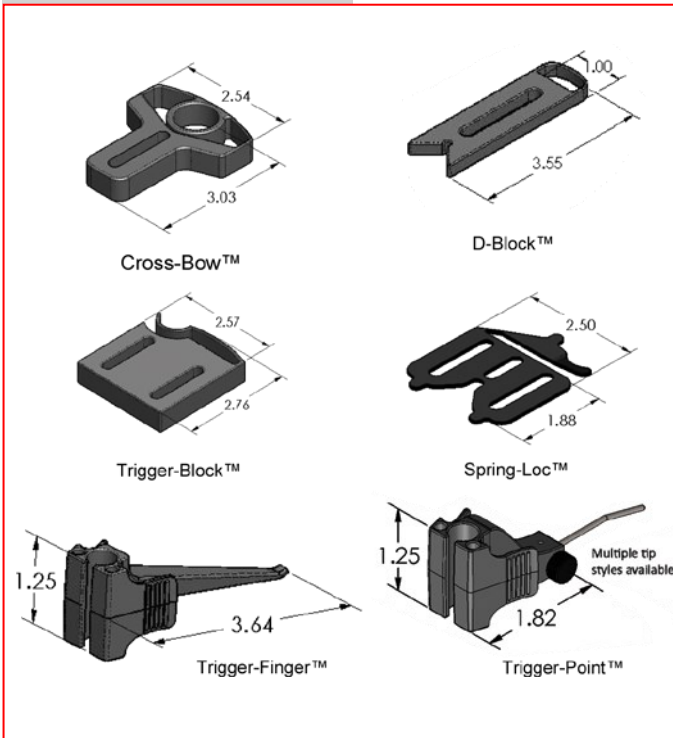

Risers and Stand-Offs

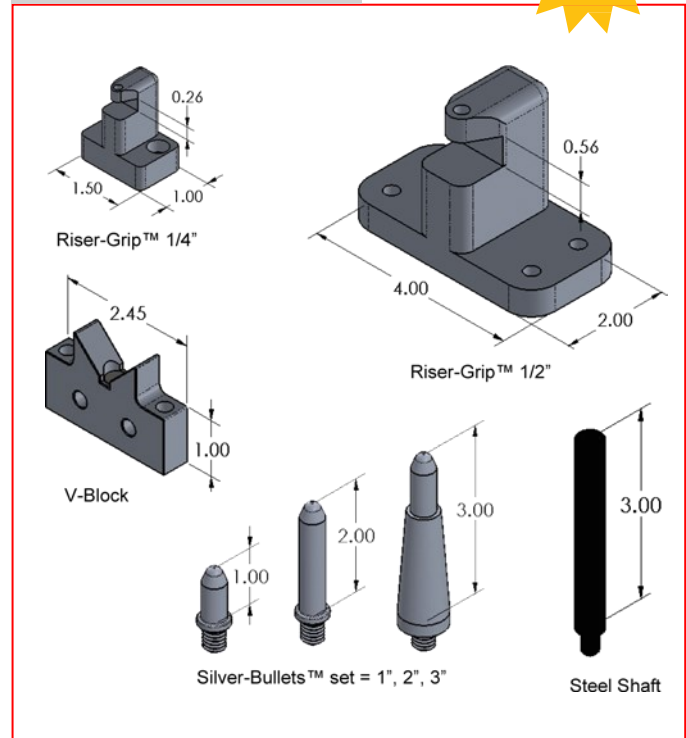

Spring Clamps (1/4-20)

Part#	Description	Qty.	Price
CRBW-30	Cross-Bow™ spring clamp	8	\$59.00
D-BLK-30	D-Block™ spring-stop	8	\$56.00
TRBL-30	Trigger-Block™ spring clamp	6	\$56.00
SPR-LOC	Spring-Loc™ low-profile clamp	2	\$79.95
TRFN-20	Trigger-Finger™ and steel shaft	4	\$99.95
TRFN-10	Trigger-Finger™ sold separately	1	\$10.95
TRPT-20	Trigger-Point™, 3 tips, steel shaft	4	\$199.00

Risers and Stand-Offs

Part#	Description	Qty.	Price
RG-250	Riser-Grip™ 1/4" opening riser	1	\$89.95
RG-500	Riser-Grip™ 1/2" opening riser	1	\$159.95
VB-001	V-Block 90° included angle	2	\$99.95
SIBU-SO-100	Silver-Bullet™ standoff (set= 1", 2", 3")	4	\$199.00
TRFN-SHAFT	3" steel shaft, stand-off		\$16.95

Inquire about metric components

Creating a LEAN QC department need not be expensive!

Get started with a docking rail, a plate and some work-holding, and add components as work requires.

Stops and Rails

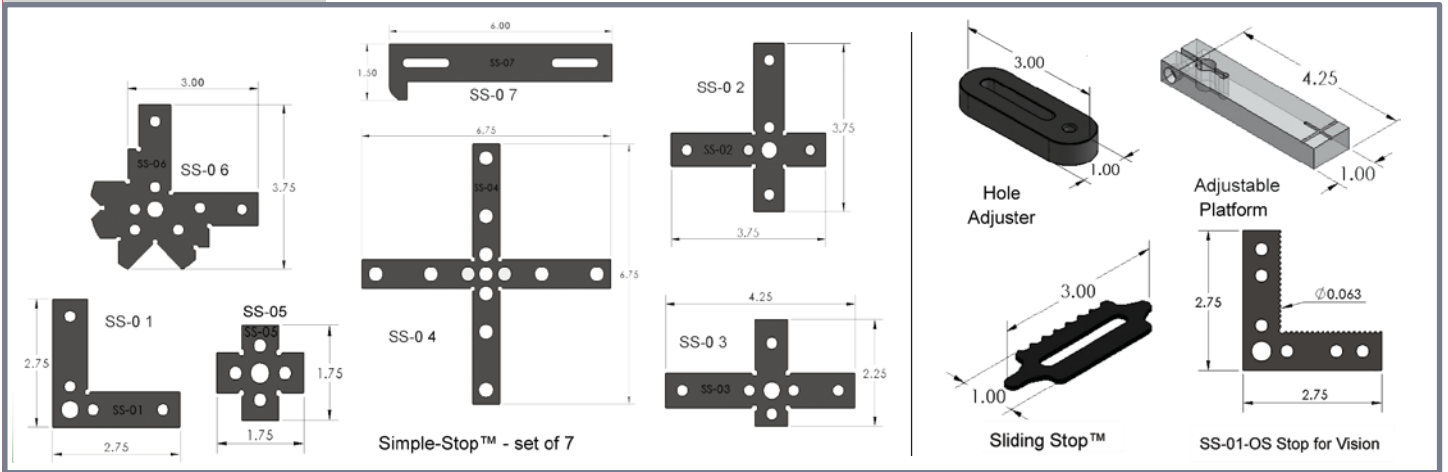

Stops and Rails			
Part#	Description	Qty.	Price
Set pn	Stainless steel. Set of 7, SS-01, SS-2, SS-03, SS-04, SS-05, SS-		
SS-01-OS	Simple-Stop™ for vision, serrated edge	1	\$69.95
ADJ-PLT-10	Adjustable platform for TRFN, TRPT	1	\$49.95
SLI-STOP	Sliding Stop™ low-profile stop	2	\$39.95

Inquire about metric



Trigger-Block™ multi-part fixture.

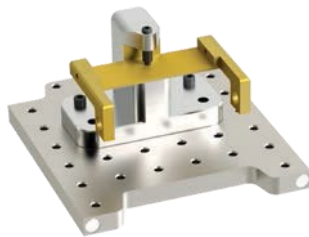

Riser-Grip™ full access clamp.

According to lean practitioners, Inspection Arsenal™ provides an opportunity to make significant quality improvements while uncovering hidden profits.

“The Inspection Arsenal™ product line eliminates many non-value added setup steps through their CMM and vision fixture plates and work holding. By ‘fixturing-up’ and simplifying the inspection task for repeatable and documented steps, a standard work opportunity has been created to speed inspection and increase the number of parts inspected, even with a less-skilled inspector. Implementation will reduce the downtime of expensive machines on the shop floor – higher machine utilization (e.g., running spindles, cutting chips) increases profits.”

Dwighd Delgado,
LEAN Six Sigma Instructor and Practitioner, CQE

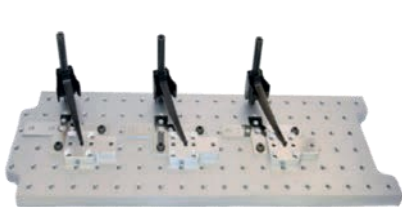

slots and hole spacing may be different than shown

Inspection Arsenal™:

Cross-Bow™

D-Block™

Loc-N-Load™

Open-Sight™

Rapid-Loc™

Silver-Bullet™

Simple-Stop™

Trigger-Block™

Trigger-Finger™

Air-Glide™

Modular Tower System

Magnetic Stand-Offs

Traditional and Enhanced Stand-Offs



For helpful product videos visit:

www.youtube.com/user/InspectionArsenal/leaninspection.com/videos

**INSPECTION
ARSENAL™**

Products of Phillips Precision, Inc

Made in the USA • Patents Pending

Starrett®

www.starrett.com